Lockable Bib Taps



Item:	Brass Hose Bibcock	Size:	½"
Brass Material:	HPB 57-3	Handle Material:	Iron or Steel
Handle Type:	Lever	Stem Type:	Double O-ring
Stem Material:	Brass	Seat Material:	PTFE
Body Seal Material:	PTFE	Working Pressure	16 bar (232Psi)
Opening/closing test:	10000 Times	Thread:	ISO228 (equivalent to DIN259 and BS2779)
Working temperature:	From -10°C to +120 °C (from 14°F to 248°F)		
High Light:	DIN 259 hose bibcock, 232psi brass ball bibcock, BS2779 brass ball bibcock		

Details

Brass Valve Body: High-density forging, no blister, no air holes, no leakages. Made by special high precision CNC machines.

Brass Bonnet: High-density forging, no blister, no air holes, no leakages. Made by special high precision CNC machines.

Valve Ball: Smooth and wear resisiting, with good sealing performance.

Brass Valve Stem: Made of hot rolled brass, high tensile strength, good toughness, long-term use without deformation, fracture.

Ball Seat: Made by pure PTFE(polytetrafluoroethylene), with high elasticity and wear resistance, is not easy aging.

O-ring: NBR , made of imported raw material, small friction coefficient, long service life and not easy to leak.

Stainless Steel Locknut: Internal design of anti-loose, can be used for long time.

Water Outlet: Made of stainless steel 304 in good quality, no deformation and rust after long-time use.

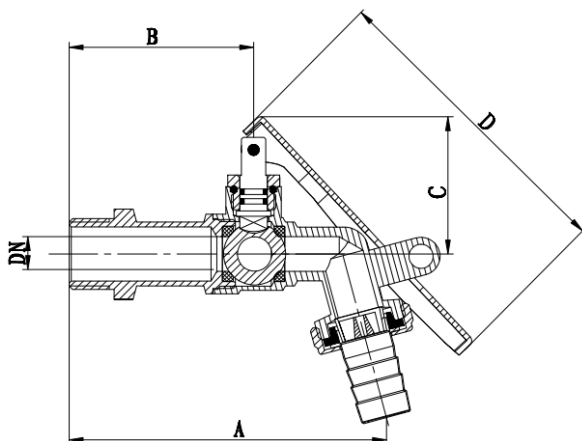

Dimension (mm)	
A	91
B	54
C	40
D	90
DN	10